

Tiger Neo N-type

72HL4-BDV

560-580 Watt

BIFACIAL MODULE WITH DUAL GLASS

N-Type

Positive power tolerance of 0~+3%

IEC61215(2016), IEC61730(2016)

ISO9001:2015: Quality Management System

ISO14001:2015: Environment Management System

ISO45001:2018

Occupational health and safety management systems

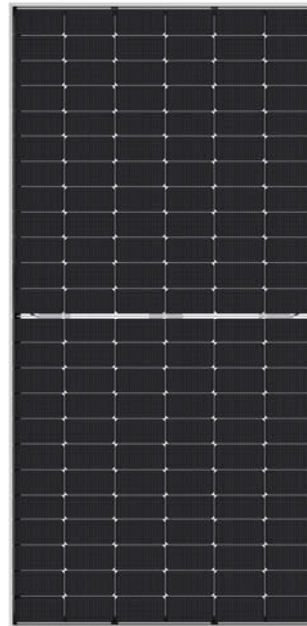

Key Features



SMBB Technology

Better light trapping and current collection to improve module power output and reliability.



PID Resistance

Excellent Anti-PID performance guarantee via optimized mass-production process and materials control.



Higher Power Output

Module power increases 5-25% generally, bringing significantly lower LCOE and higher IRR.



Hot 2.0 Technology

The N-type module with Hot 2.0 technology has better reliability and lower LID/LETID.



Enhanced Mechanical Load

Certified to withstand: wind load (2400 Pascal) and snow load (5400 Pascal).



LINEAR PERFORMANCE WARRANTY

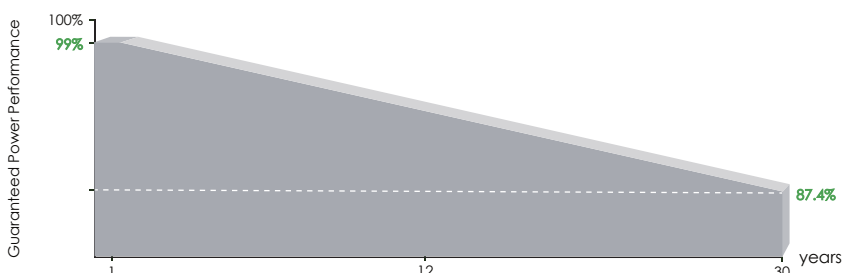

12 Year Product Warranty

30 Year Linear Power Warranty

0.40% Annual Degradation Over 30 years

Engineering Drawings

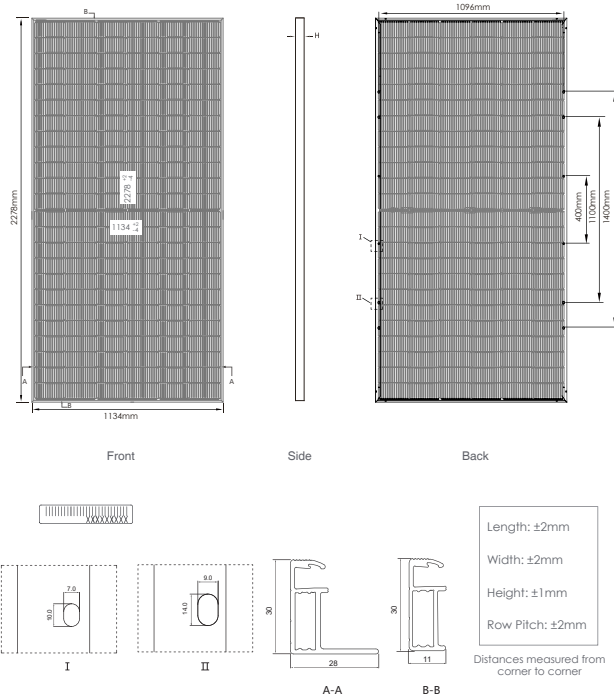

For detailed sizes and tolerance specification, please consult detailed module drawing

Packaging Configuration

(Two pallets = One stack)

36pcs/pallets, 72pcs/stack, 720pcs/ 40'HQ Container

Electrical Performance & Temperature Dependence

Current-Voltage & Power-Voltage Curves (570W)

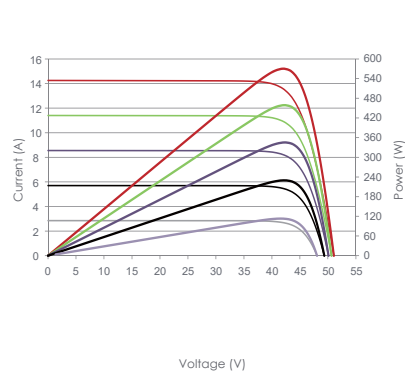

Temperature Dependence of Isc, Voc, Pmax

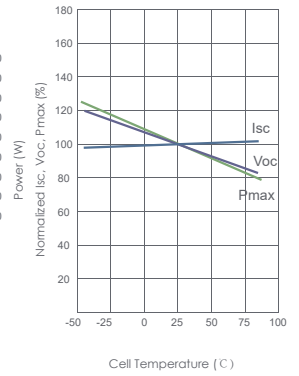

Mechanical Characteristics

Cell Type	N type Mono-crystalline
No. of cells	144 (2×72)
Dimensions	2278×1134×30mm (89.69×44.65×1.18 inch)
Weight	32 kg (70.55 lbs)
Front Glass	2.0mm, Anti-Reflection Coating
Back Glass	2.0mm, Heat Strengthened Glass
Frame	Anodized Aluminium Alloy
Junction Box	IP68 Rated
Output Cables	TUV 1×4.0mm ² (+): 400mm , (-): 200mm or Customized Length

SPECIFICATIONS

Module Type	JKM560N-72HL4-BDV		JKM565N-72HL4-BDV		JKM570N-72HL4-BDV		JKM575N-72HL4-BDV		JKM580N-72HL4-BDV	
	STC	NOCT	STC	NOCT	STC	NOCT	STC	NOCT	STC	NOCT
Maximum Power (Pmax)	560Wp	421Wp	565Wp	425Wp	570Wp	429Wp	575Wp	432Wp	580Wp	436Wp
Maximum Power Voltage (Vmp)	41.95V	39.39V	42.14V	39.52V	42.29V	39.65V	42.44V	39.78V	42.59V	39.87V
Maximum Power Current (Imp)	13.35A	10.69A	13.41A	10.75A	13.48A	10.81A	13.55A	10.87A	13.62A	10.94A
Open-circuit Voltage (Voc)	50.67V	48.13V	50.87V	48.32V	51.07V	48.51V	51.27V	48.70V	51.47V	48.89V
Short-circuit Current (Isc)	14.13A	11.41A	14.19A	11.46A	14.25A	11.50A	14.31A	11.55A	14.37A	11.60A
Module Efficiency STC (%)	21.68%		21.87%		22.07%		22.26%		22.45%	
Operating Temperature (°C)	-40°C~+85°C									
Maximum system voltage	1500VDC (IEC)									
Maximum series fuse rating	30A									
Power tolerance	0~+3%									
Temperature coefficients of Pmax	-0.29%/°C									
Temperature coefficients of Voc	-0.25%/°C									
Temperature coefficients of Isc	0.045%/°C									
Nominal operating cell temperature (NOCT)	45±2°C									
Refer. Bifacial Factor	80±5%									

*STC: Irradiance 1000W/m² Cell Temperature 25°C

AM=1.5

NOCT: Irradiance 800W/m² Ambient Temperature 20°C

AM=1.5

Wind Speed 1m/s